

OKL CAN LINE INC.

Aluminum Parallel Motion Assembly for Ragsdale Style BM's

US Patent # D467600

Serving the can making
industry.....worldwide.

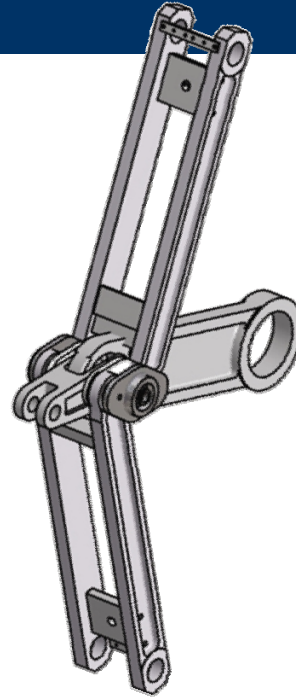

OKL's Aluminum Parallel Motion Assembly (APMA) was developed as a high speed / high strength yet lightweight alternative for the original steel unit. It incorporates aircraft grade materials with unique Engineering design , the result allows for today's requirements for higher speeds , lower maintenance costs and safety.

- ◆ 50% lighter and 400% stronger than standard steel units.
- ◆ Higher speeds with less vibrations.
- ◆ Ease of installation for higher safety standards and reduced downtime.

OKL Can Line Inc.

11235 Sebring Drive
Cincinnati, OH
45240
USA

Phone: + 1 513 825 1655

Fax: + 1 513 825 1948

WWW.OKLcan.com



Aluminum Parallel Motion Assembly (APMA)

US Patent # D467600

- ◆ Upper and lower idler arms are direct replacements for standard steel units.
- ◆ Built from 70-75 T5 aluminum.
- ◆ No proprietary bearings.
- ◆ Minor modifications for initial installation.
- ◆ Ease of maintenance.



Serving the can making industry.....worldwide.

OKL Can line

11235 Sebring Drive
Cincinnati, OH
45240

Phone: + 1 513 825 1655

Fax: + 1 513 825 1948

WWW.OKLcan.com

